



Kamber HANDGUN MODEL 8



**PRECISION MADE IN SWITZERLAND AND DISTRIBUTED EXCLUSIVELY BY
M-B COMPANIES, INC.
IN NORTH AMERICA**

Pavement Marking Equipment Divisions
Eastern Region
79 Montgomery Street
Montgomery, PA 17752
1-570-547-1621

Western Region
2490 Ewald Avenue SE
Salem, OR 97302
1-503-364-2909

FOR PRICE AND DELIVERY INFORMATION
CONTACT

EAST COAST
DAVID KLINGER
1-800-233-8461 EXT 522
FAX 570-547-0619

WEST COAST
STEVE CHRISTIE
1-800-253-2909 EXT 311
FAX 503-585-0617

FOR TECHNICAL SERVICE
1-888-323-2900

CORPORATE HEADQUARTERS
1615 WISCONSIN AVENUE
NEW HOLSTEIN, WI 53061
920-898-4203
920-898-4588 FAX

M-B COMPANIES, INC.
KAMBER PAINT SPRAY GUN
MODEL 8 HAND GUN

The Kamber Model 38 Spray Gun is a high-quality, pneumatic paint gun, manufactured under the strictest control of materials and workmanship, unequaled by any other manufacturer. The gun is designed for road marking application of all standard traffic paints, including premix. The paint line delineation on the road is excellent and, with most paint, equals that of an airless system.

Before use of this gun it is very important to read the instructions carefully and follow all directions.

CAUTION: Never aim the gun at a person!!

This gun is used exclusively for road marking materials.

MAXIMUM USE PRESSURE 284 PSI

All the materials of this gun are able to be recycled and are ecologically friendly. Gun is completely rust resistant; parts are made of high quality material:

TECHNICAL DATA:

High productivity gun with flat jet ONLY.

Opening system for atomizing air and paint through trigger are completely separate, with no gaskets used.

Special needle and material nozzle provides an absolute closing, even with paints with glass beads or other components.

The double-barreled air nozzle system is unique, with high precision engineering.

- a. basic air nozzle for air consumption
- b. exterior nozzle for the line width

Air consumption, which is very low for the output, does not vary even if the exterior nozzle is worn. On the other hand, without varying the air consumption, you can obtain, with the front nozzle, spraying widths ranging from 1.97 to 19.69 inches.

Material Nozzle: the following sizes are available:

∅ 2.0 mm	=	Paint passage	3.14	mm ²
∅ 3.0 mm	=	Paint passage	7.06	mm ²
∅ 3.5 mm	=	Paint passage	9.61	mm ²
∅ 4.0 mm	=	Paint passage	12.56	mm ²
∅ 4.5 mm	=	Paint passage	19.62	mm ²
∅ 6.2 mm	=	Paint passage	28.26	mm ²

Exterior nozzle in stainless steel or hard metal: (only exterior nozzles with the letter “K” are Kamber Nozzles). Available for spraying widths of 1.97 to 19.69 inches.

The sets of nozzles available allow a precise adaptation of the spray gun to all usual or special road marking paints, cold or hot spray, as well as paints with anti-skid products or glass beads.

Spraying application by tank under pressure/by low pressure pump.

Effective air consumption: at a pressure 60 PSI for material nozzle

∅ 2.0 mm	about	30.8 - 39.6	gal/min
∅ 3.0 mm	about	30.8 – 39.6	gal/min
∅ 3.5 mm	about	30.8 – 39.6	gal/min
∅ 4.0 mm	about	30.8 – 39.6	gal/min
∅ 4.5 mm	about	52.8 – 66.0	gal/min
∅ 6.2 mm	about	52.8 – 66.0	gal/min

These values depend on the used pressure and the hose diameter and thereby can change. Only an air hose for diffusion and design with an internal diameter of 10 mm will give you a good result.

Pressure – Diffusion: 42.66 to 63.99 PSI

GUN DESIGN:

Nuts and exterior nozzles are identical to the Models 38 and 84. basic air nozzles and material nozzles are identical with Model 84, thereby these parts are interchangeable.

DIMENSIONS:

Length: 7.49 Inches

Width: 1.68 Inches

Weight: 5.63 Pounds

WARRANTY: 1 year on all parts for any fault in the manufacturing.

MAINTENANCE:

1. Never soak the gun entirely in thinner (Solvent)
2. Once a month, grease the spring #66050714
3. Never grease the valve #66050718
4. Nozzle Cleaning:
Quick Cleaning – Cleaning the paint passage in the gun. For all kinds of flushing of the machine, either quick flushing or flushing of the gun with material hose, always remove exterior nozzle (slot nozzle), otherwise the paint is pressed back into the air system of the gun. Maximum flushing pressure is 14.22 to 28.44 PSI.
Or
Remove the exterior nozzle and the basic air nozzle and soak them over night in solvent.

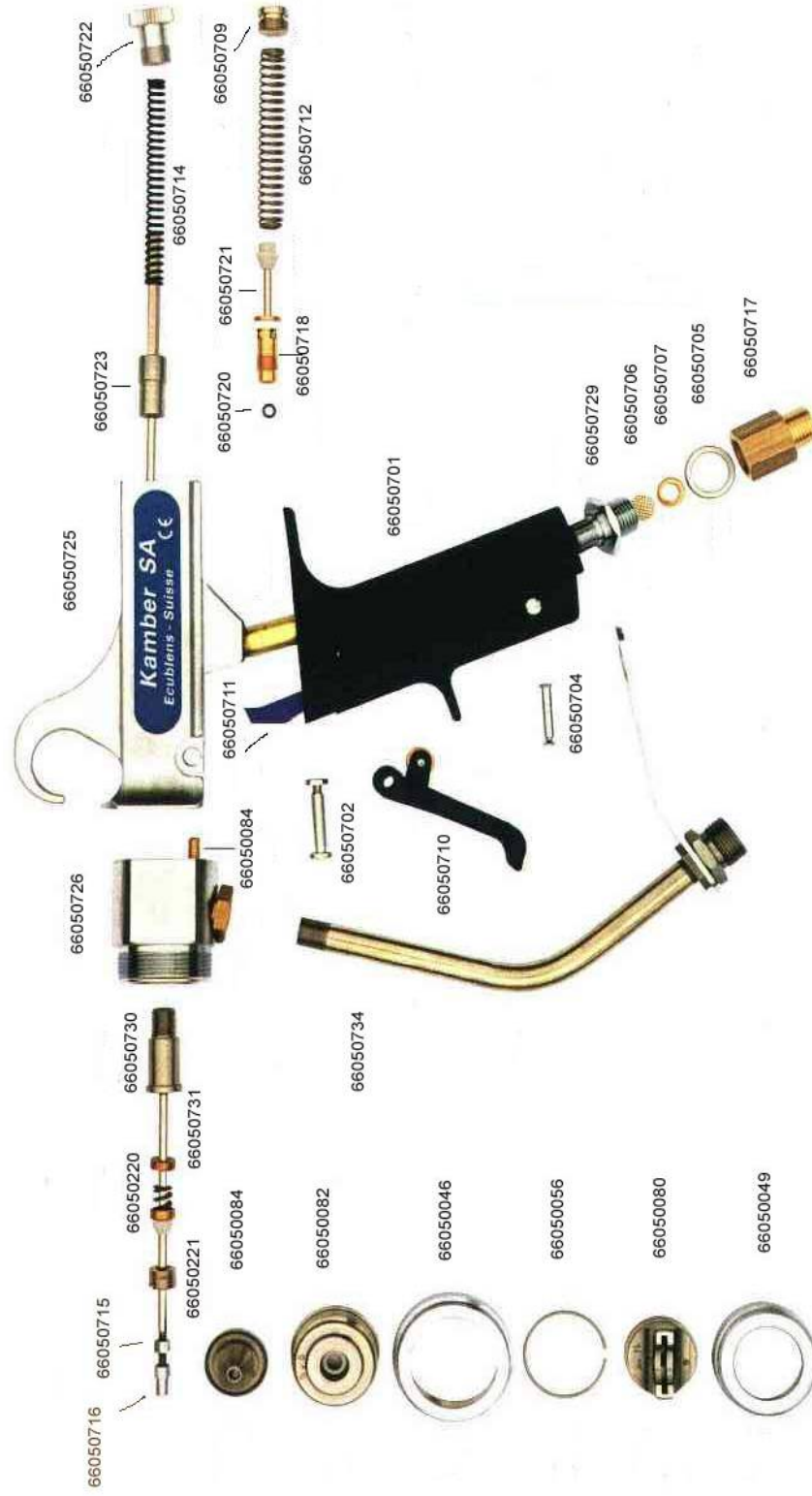

Kamber Model 8

LONGE 400 mm. COMPLETE N°18099 POUR MOD. 8 HR ET 14 HR
COMPLETE OVERALL LENGTH 400 mm. # 18099 FOR GUNS MOD. 8 HR AND 14 HR

VERLÄNGERUNG 400 mm. KOMPLETT NR. 18099 FÜR PISTOLEN MOD. 8 HR UND 14 HR
PROLUNGA 400 mm. N° 18099 COMPLETA PER PISTOLE MOD. 8 HR E 14 HR

18099 A



18099 B



26

8523

18099 C

*8064

8064 B



* Indiquer N° ou Ø
* Nr. oder Ø angeben
* Indicate # or diameter
* Indicare N° ovvero Ø

KAMBER HAND GUN MODEL 8 PARTS LIST

PART#	DESCRIPTION
66050400	Complete Kamber Model 8 Gun
66050046	Fixing Nut
66050080	Exterior Nozzle in Hard Metal Indicate # 3-10-16
66050701	Grip
66050702	Long Screw for Trigger
66050703	Short Screw for Trigger
66050704	Long Screw for Lever
66050705	Distance Ring Under Handle
66050706	Filter
66050707	Filter Nut
66050708	Short Screw for Lever
66050709	Valve Cap
66050710	Trigger
66050711	Lever
66050054	Guide for Head of Gun
66050712	Stainless Steel Valve Spring
66050713	Needle Counter Nut
66050714	Strong Needle Spring
66050056	Check-ring for Air Nozzle
66050220	Needle Packing Teflon with Spring
66050221	Needle Packing Nut
66050715	Counter-Nut for Needle Head
66050716	Chrome Needle Head 5.0mm
66050717	Air Hose Connect

PART#	DESCRIPTION
66050718	Valve Body
66050719	Teflon Gasket
66050720	"O"-Ring for Valve Body
66050721	Valve With Shaft Head
66050082	Basic Air Nozzle
66050084	Material Nozzle 4.0
66050722	Needle Adjusting Screw
66050723	Stainless Steel Needle Fixing Socket
66050724	Cap for the Body
66050725	Body of the Gun (Model 8)
66050726	Head for Gun with 1.5mm Screw
66050728	Air Pipe with Fitting
66050729	Air Fitting
66050730	Stainless Steel Screw Fasten Head of Gun
66050731	Hard Chrome Needle w/o Head 8064/C/D/E/F
66050732	Needle Alone 5.0mm without 8523/8026
66050733	Repair Kit
66050734	Material Hose Connection, 3/8"
66050735	Exterior Tube Alone
66050736	Interior Tube Alone
66050737	Needle Alone for Lengthening Model 8

Kamber MODEL 8 HAND GUN

REPAIR KIT PARTS LIST

PART #	DESCRIPTION
66050733	Repair Kit
66050702	Long Screw for Trigger
66050703	Short Screw for Trigger
66050704	Long Screw for Lever
66050706	Filter
66050708	Short Screw for Lever
66050712	Stainless Steel Valve Spring
66050714	Stainless Steel Needle Spring
66050220	Needle Packing With Teflon Spring
66050221	Nut Clamp For Needle Packing
66050718	Valve Body
66050719	Teflon Gasket for Valve Body
66050720	"O"-Ring for Valve Body
66050721	Valve Shaft with Teflon Head
66050722	Needle Adjusting Screw



M-B Companies, Inc.

Administration

1615 Wisconsin Avenue
P.O. Box 200
New Holstein, WI 53061
Phone: 800-558-5800
FAX: 920-898-4588

Pavement Marking Equipment Divisions

EAST COAST DIVISION
79 Montgomery Street
Montgomery, PA 17752
Phone: 888-323-2900
FAX: 570-547-1629

WEST COAST DIVISION
2490 Ewald S.E.
Salem, OR 97302
Phone: 800-253-2909
FAX: 503-370-4389

