



# Kamber PAINT GUN

---

## MODEL 38-20



**PRECISION MADE IN SWITZERLAND AND DISTRIBUTED EXCLUSIVELY BY  
M-B COMPANIES, INC.  
IN NORTH AMERICA**

Pavement Marking Equipment Divisions  
Eastern Region  
79 Montgomery Street  
Montgomery, PA 17752  
1-570-547-1621

Western Region  
2490 Ewald Avenue SE  
Salem, OR 97302  
1-503-364-2909

# **Kamber** PAINT GUN MODEL 38-20

## FOR PRICE AND DELIVERY INFORMATION CONTACT

EAST COAST  
DAVID KLINGER  
1-800-233-8461 EXT 522  
FAX 570-547-0619

WEST COAST  
STEVE CHRISTIE  
1-800-253-2909 EXT 311  
FAX 503-585-0617

FOR TECHNICAL SERVICE  
1-888-323-2900

CORPORATE HEADQUARTERS  
1615 WISCONSIN AVENUE  
NEW HOLSTEIN, WI 53061  
920-898-4203  
920-898-4588 FAX

# **KAMBER SPRAY GUN MODEL 38-20**

The Kamber Model 38-20 Spray Gun is a high-quality, pneumatic paint gun, manufactured under the strictest control of materials and workmanship, unequaled by any other manufacturer. The gun is designed for road marking application of all standard traffic paints, including premix. The paint line delineation on the road is excellent and, with most paint, equals that of an airless system.

## **TECHNICAL DATA**

Atomizing air flow (non-bleeder type) with automatic internal valve.

Easily converted to bleeder type if desired.

Operating air, atomizing air and flow of material are completely separate, with no gaskets used.

Double-barreled air nozzle system is unique, resulting in very low air consumption for the paint output, which does not vary even if the exterior nozzle is worn.

By changing the exterior nozzle, spray widths ranging from 2 inches to 12 inches can be obtained without affecting air consumption.

## **PAINT**

The set of nozzles available allow a precise adaptation of the spray gun to all unusual or special; road marking paints, cold, or hot, as well as premix.

Effective air consumption at 60psi for material nozzle: ¼" nozzle – 15 to 25 CFM – viscosity 90 to 110 KU.

## **DIMENSIONS**

Length – 8 ½"

Width - 2"

Weight – 5 lb, 14 oz

## **WARRANTY**

One year on all parts for any fault in manufacturing.

## **GUN MAINTENANCE**

Before use, fill the gun's center section with grease. It is recommended that the special protective guard plate be reinstalled on the gun after maintenance to protect the gun's valve parts from glass spheres

### **MATERIAL NOZZLE:**

ALWAYS TIGHTEN MATERIAL NOZZLE WITH A WRENCH PRIOR TO USE.

### **NEEDLE GASKETS:**

The needle gaskets are of new highly resistant material and can be expected to last an entire season. With the special key provided with the gun, tightening or loosening of the needle gaskets is accomplished without disassembling the gun.

### **MOVEMENT OF THE GUN: (Pneumatic Piston)**

**NEVER** dip the gun in thinner or any other solvent. Once a week, put a few drops of oil in the connection (cylinder side).

### **CLEANING THE PAINT PASSAGE IN THE GUN:**

**VERY IMPORTANT:** Always remove exterior nozzle (Slot Nozzle).

For flushing of the paint passage of the gun, always remove exterior nozzle (slot nozzle), otherwise the paint is pressed back into the air system of the gun. Maximum flushing pressure is 15 to 30psi.

### **FLUSHING OF THE ATOMIZING PASSAAGE OF THE GUN:**

BLEEDER GUN – Solvent may be flushed through the atomizing port of the paint gun while machine is in motion by use of a 3-way air and flushing valve.

## **SIZE SELECTION**

### **HOSE SELECTION:**

A. Operating Air Hose:

Use a 5/16" or 3/8" air hose and connect to the operating port of the paint gun (UPPER PORT).

B. Atomizing Air Hose:

Use a 3/8" air hose minimum and connect to the atomizing port of the paint gun (MIDDEL PORT).

C. Paint Hose:

Use a 1/2" paint hose, minimum, and connect to the paint port of the paint gun (LOWER PORT).

### **NOZZLE SIZE SELECTION:**

The size of the machine and speed of operation determines the size of the Kamber Spray Gun material and air nozzle that will insure the best performance.

Before choosing the set of nozzles for the spray gun, compare the effective output of the compressor on the machine the consumption for each size nozzle.

The nozzles described are standard parts for average viscosity material and speeds. For additional information regarding special applications, please contact your Lafarge Road Marking representative.

#### **STANDARD PARTS**

#### **MODEL 38-20**

Material Nozzle

6.8

Air Nozzle

8.9-14

Exterior Nozzle

Line Width 4 to 7"

42-10-25

Line Width 8 to 12"

44

Needle

2022-7.5

Effective Air

15-25 CFM @ 50-100 psi

Basic Air Nozzle:

The basic air nozzle determines the air consumption of the gun. For the correct air consumption, the basic nozzle must correspond to the number indicated on the list of nozzles. The number engraved on the nozzle indicates the diameter of the hole. The basic air nozzle does not influence the width of spray; only the external nozzle determines the width.

**OPERATING INSTRUCTIONS**

1. **PRESSURE:**

For piston operation – 40psi to 60psi.

2. **PRESSURE FOR ATOMIZING AND PAINT:**

This gun, due to the special; construction of the air nozzle, can be operated with an atomizing pressure lower than the pressure in the material tank or in the low pressure pumps.

The lower pair pressure for atomizing, compared to the pressure in the paint tank, the larger the effective paint output of the gun

**KAMBER GUN  
LINE WIDTH CHART**

<b>GUN EXTERIOR NOZZLE</b>				
<b>GUN MODEL</b>	<b>LINE WIDTH</b>	<b>NOZZLE NO</b>	<b>HEIGHT FROM ROAD</b>	<b>WITH SHROUD</b>
38-20	4"	42-10-25	3"	2 ½ "
	6"	42-10-25	4 ½ "	4"
	8"	42-10-25	6"	5 ¾"
	8"	44	5"	
	10"	44	6"	
	12"	44	7 ½"	

NOTE: Height of gun may vary from chart depending on paint pressure and atomizing pressure.

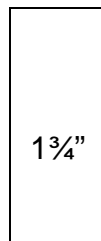

KAMBER SHROUD #3310201005



Kamber Model 38-20

59



29



34



26



# Kamber Model 38-20



# SPARE PARTS LIST

## PNEUMATIC PAINT SPRAY GUN

### MODEL 38-20

ITEM #	PART#	DESCRIPTION
	66050102	Spray Gun Complete
	66050227	Repair Kit Common Repair
	66050228	Repair Kit Complete with Socket
	66050229	Set of Repair Tools
1	66050201	Body of Gun
2	66050202	Head of Gun W 1.5mm Screw
3	66050203	Valve Body W/O-Ring
4	66050204	Nut F/Valve Body
5	66050205	Transmission Lever
6	66050206	Material Connection
7	66050207	Hard Chrome Needle
8	66050208	Counter Nut to Needle Head
9	66050209	Needle Head
10	66050210	Nylon Gasket
11	66050211	Valve Spring
12	66050212	Nylon Ball Valve
13	66050213	Valve Shaft
14	66050214	Packing Nut
15	66050215	O-Ring for Packing Nut #14
16	66050216	O-Ring for Valve Body #3
17	66050034	Stainless Steel Bushing
18	66050037	Cylinder Cover
19	66050038	Stainless Steel Piston Axle
20	66050039	Distance Ring, Piston Ring
21	66050040	Main Screw for Sleeve Fixing
22	66050019	GRACO U-Ring
23	66050042	Stainless Steel Check Nut on Axle #65
24	66050029	Valve Spring
25	66050044	Center Needle Spring
26		No. 12 Fork Wrench
27	66050026	Check Screw for Needle M3-3
28	66050046	Fixing Nut for Basic Air Nozzle
29	66050048	Key for Tightening Needle Packing Nut
30	66050049	Fixing Nut For Exterior Nozzle
31	66050050	Cap
32	66050031	Distance Ring
33	66050020	Filter
34		Wrench for Socket Head Cap Screw
35	66050023	Nylon Gasket on Shaft #49 - #20
36	66050051	Copper Gasket on Shaft Between #49 - #20

**SPARE PARTS LIST – CONTD  
PNEUMATIC PAINT SPRAY GUN  
MODEL 38-20**

ITEM #	PART #	DESCRIPTION
37	66050052	Copper Gasket, 2-piece between #14 Body
38	66050219	Double Male Adapter
39	66050053	Nut to fasten Air Filter
40	66050054	Guide for Head of Gun
41	66050055	Stainless Steel Screw, Fasten Head
42	66050056	Tension Spring For Air Filter
43	66050220	Teflon Gasket with Spring
44	66050021	Needle Packing Nut for Gasket #43
45	66050065	Material Nozzle 6.8mm
46	66050064	Basic Air Nozzle (S.S.) or H.M.) 8.9mm
47	66050074	Exterior Air Nozzle, Hard Metal 42-10-25
48	66050059	Exterior Air Nozzle, Hard Metal 41-14-25
49	3320201035	Nylon Sealing Washer
50	66050223	Guard Plate
51	66050225	Screw for Guard Plate
52	3310201005	Gun Shroud
53	3320201039	Mount
54		Thumb Screws
55		Locking Screws
56		Screw and Jam Nut
57	1120201002	Gun Mounting Post

**SPARE PARTS LIST  
PNEUMATIC PAINT SPRAY GUN  
MODEL 38-20**

ITEM #	PART #	DESCRIPTION
	66050200	Spray Gun Complete
	66050227*	Repair Kit – Common Repairs
	66050228	Repair Kit – Complete with Socket
10*	66050210	Nylon Gasket
13*	66050213	Valve Shaft
14*	66050214	Packing Nut
15*	66050215	“O”-Ring for Packing Nut #14
16*	66050216	“O”-Ring to Valve Body #3
22*	66050019	GRACO U-Ring
24	66050029	Piston Ring
25	66050044	Center Needle Spring
27*	66050026	Check Screw F/Needle M 3-3
33*	66050020	Filter
35*	66050023	Nylon Gasket on Shaft #409 - #20
36*	66050051	Copper Gasket on shaft between #40 - #20
37*	66050052	Copper Gasket, 2 piece between #49 - #20
40*	66050054	Guide F/Head of Gun
41*	66050055	Stainless Steel Screw, Fasten Head
43*	66050220	Teflon Gasket W./Spring
44*	66050221	Needle Packing Nut F/Gasket #43

\* These parts ONLY are supplied in COMMON REPAIR KIT.

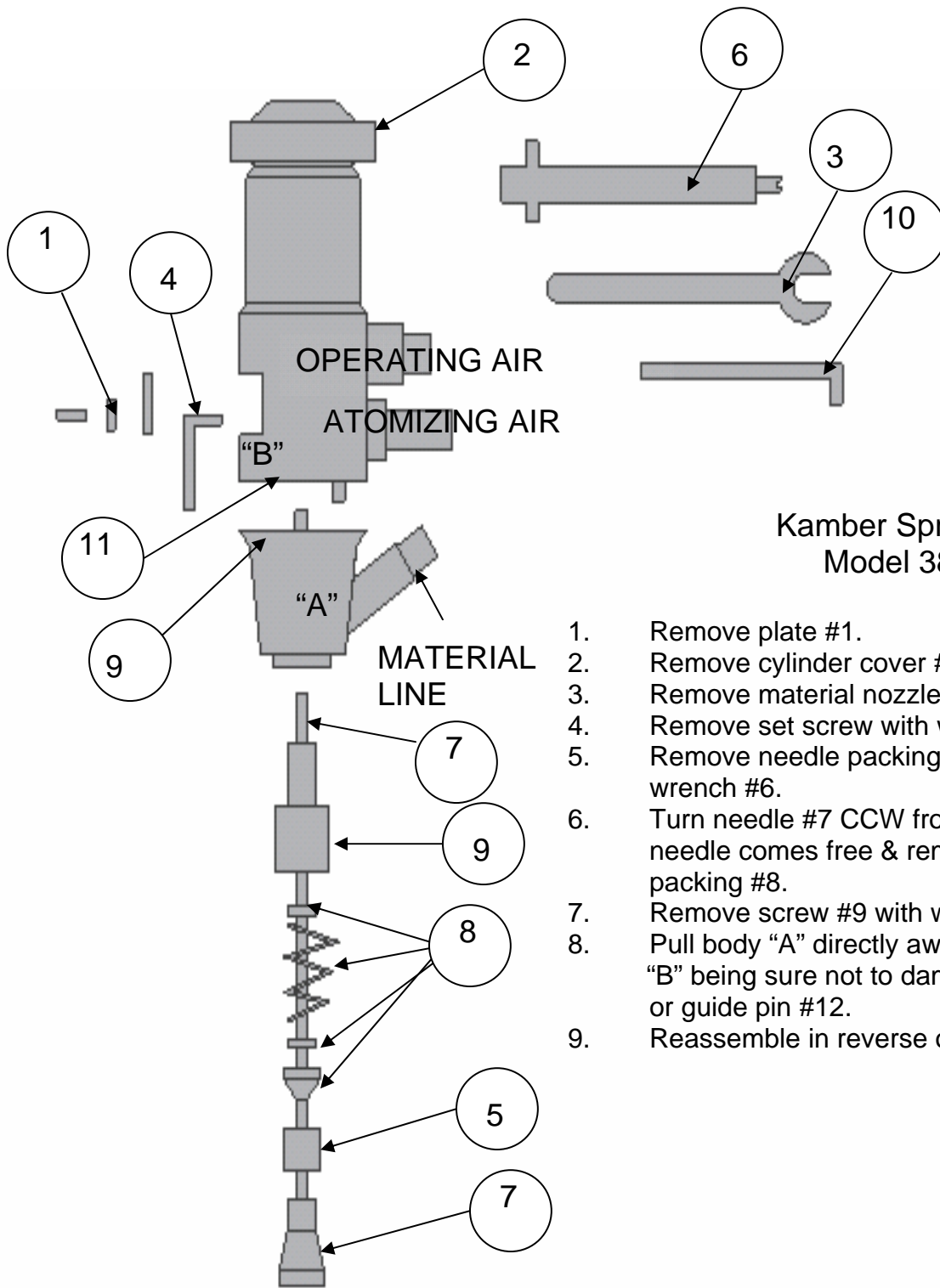

Kamber Spray Gun  
Model 38-20

1. Remove plate #1.
2. Remove cylinder cover #2.
3. Remove material nozzle with wrench #3.
4. Remove set screw with wrench #4.
5. Remove needle packing nut #5 with wrench #6.
6. Turn needle #7 CCW from bottom until needle comes free & remove needle and packing #8.
7. Remove screw #9 with wrench #10.
8. Pull body "A" directly away from body "B" being sure not to damage gasket #11 or guide pin #12.
9. Reassemble in reverse order.

### NON-BLEEDER KIT

VALVE SHAFT 66050213  
O-RING 66050216  
BALL VALVE 66050212  
VALVE SPRING 66050211  
LOCKING NUT 66050127  
(For Valve Body)

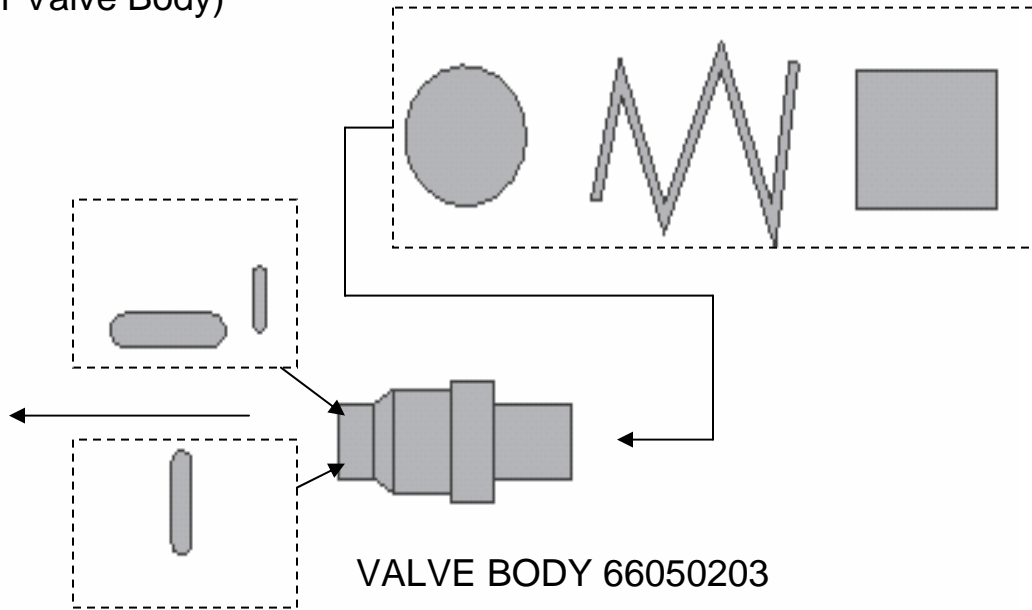
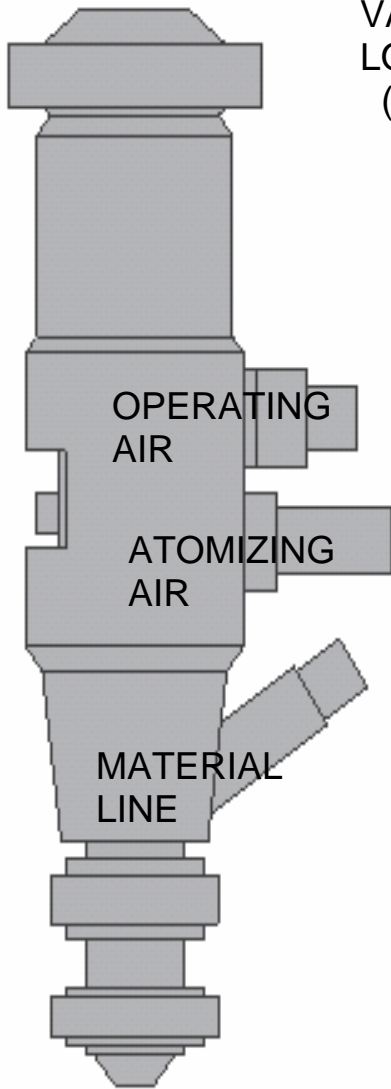

VALVE BODY 66050203

BLEEDER KIT  
NYLON SEALING WASHER  
(3320201035 5/16")  
(3320201035A 1/4")

## KAMBER SPRAY GUN MODEL 38-20



# M-B Companies, Inc.

---

**Administration**

1615 Wisconsin Avenue  
P.O. Box 200  
New Holstein, WI 53061  
Phone: 800-558-5800  
FAX: 920-898-4588

**Pavement Marking Equipment Divisions**

**EAST COAST DIVISION**  
79 Montgomery Street  
Montgomery, PA 17752  
Phone: 888-323-2900  
FAX: 570-547-1629

**WEST COAST DIVISION**  
2490 Ewald S.E.  
Salem, OR 97302  
Phone: 800-253-2909  
FAX: 503-370-4389

